

**LEGEND**

- UNDERGROUND COMMUNICATIONS ASSETS
- SITE BOUNDARY
- PROPOSED 75-400L SEMI-MATURE TREE
- ADVANCED SPECIMEN AT TIME OF PLANTING WITH ELEVATED CROWN AND SINGLE LEADER. ROOTBALL TO BE AT LEAST 400L WITH AT LEAST 2M OF CLEAR TRUNK IN ORDER TO MAINTAIN SIGHT LINES WITHIN THE CARPARK.

**TREE PALETTE**

REFER TO PLANT PALETTE AND SCHEDULE - LDA-007 FOR INFORMATION ON INSTALL SIZE, MATURE HEIGHTS AND NUMBER PROPOSED.

**DECIDUOUS BOUNDARY PLANTING**

MIX OF ORNAMENTAL DECIDUOUS SPECIES TO COMPLEMENT EXISTING COUNCIL PLANTING IN NEARBY STREET VERGES AND RAILWAY CORRIDOR.

ULMUS 'FASTIGIATA'

POPULUS 'VARIEGATA'

**LARGE NATIVE TREE**

TALL (>12M) NATIVE TREES TO PROVIDE YEAR-ROUND SHADE, IMPROVE ENVIRONMENTAL AMENITY AND REQUIRE LOW MAINTENANCE.

EUCALYPTUS A.

**COMPACT NATIVE PLANTING**

SMALL (6-8M) NATIVE TREES TO PROVIDE YEAR-ROUND SHADE, ATTRACT NATIVE FAUNA AND REQUIRE LOW MAINTENANCE. COMPACT SIZE WILL ALLOW TREE AMENITY TO BE PROVIDED IN TIGHTER SPACES.

WATERHOUSEA

TRISTANIOPSIS

**COMPACT DECIDUOUS FEATURE TREES**

SMALL (6-8M) ORNAMENTAL DECIDUOUS TREES PROVIDE SEASONAL COLOUR AND SOLAR ACCESS IN WINTER TO CAFE COURTYARD. COMPACT SIZE WILL ALLOW MULTIPLE SPECIMENS TO BE PLANTED IN FORMAL ROW.

PRUNUS 'NIGRA'

**MEDIUM NATIVE PLANTING**

MEDIUM SIZE (8-12M) NATIVE TREES TO PROVIDE YEAR-ROUND SHADE, IMPROVE ENVIRONMENTAL AMENITY AND REQUIRE LOW MAINTENANCE. SPECIES CHOSEN WILL PROVIDE CANOPY COVER AND VISUAL INTEREST THROUGH FLOWERS AND FOLIAGE.

EUCALYPTUS CIN.

MELALEUCA

**BOUNDARY SCREENING**

LOW MAINTENANCE NATIVE SPECIES TO PROVIDE VISUAL AND AURAL SCREENING ON BOUNDARIES. FLOWERING AND FRUITING SPECIES HAVE BEEN SELECTED TO IMPROVE ENVIRONMENTAL AMENITY.

CALLISTEMON 'SLIM'

ACMENA 'SUBLIME'



TREES



EUCALYPTUS AMPLIFOLIA



EUCALYPTUS CINEREA



MELALEUCA STYPHELIOIDES



POPULUS 'FASTIGIATA'



PRUNUS 'NIGRA'



TRISTANIOPSIS 'LUSCIOUS'



ULMUS VARIEGATA



WATERHOUSEA FLORIBUNDA

SHRUBS AND CLIMBERS



ACMENA 'SUBLIME'



CALLISTEMON 'SLIM'



CALLISTEMON 'GREEN JOHN'



CALLISTEMON 'WHITE ANZAC'



CORREA 'COLIBAN RIVER'



PANDOREA PANDORANA



RAPHIOLEPIS 'ORIENTAL PEARL'



WESTRINGIA 'AUSSIE BOX'

GRASSES & GROUNDCOVERS



BANKSIA 'BIRTHDAY CANDLES'



CHRYSOCEPHALUM APICULATUM



GREVILLEA 'GOLD CLUSTER'



GREVILLEA 'NEW BLOOD'



GREVILLEA 'ROYAL MANTLE'



JUNIPERUS CONFERTA



LOMANDRA 'TANIKA'



MYOPORUM PARVIFOLIUM

INDICATIVE PLANT PALETTE

PLANT NAME	MATURE HEIGHT	POT SIZE	SPACING	NATIVE	QUANTITY
TREES					
EUCALYPTUS AMPLIFOLIA (CABBAGE GUM)	15-20M	200L	AS SHOWN	✓	2
EUCALYPTUS CINEREA (ARGYLE APPLE)	10-15M	200L	AS SHOWN	✓	2
MELALEUCA STYPHELIOIDES (PRICKLY LEAVED PAPERBARK)	8-10M	400L	AS SHOWN	✓	2
POPULUS 'FASTIGIATA'	15-20M	400L	AS SHOWN		2
PRUNUS 'NIGRA'	4-5M	100L	AS SHOWN		3
TRISTANIOPSIS 'LUSCIOUS'	8M	100-400L*	AS SHOWN	✓	10
ULMUS 'VARIEGATA'	10-15M	100L	AS SHOWN		1
WATERHOUSEA FLORIBUNDA (WEEPING LILLY PILLY)	10-15M	100-400L*	AS SHOWN	✓	7
SHRUBS AND CLIMBERS					
ACMENA 'SUBLIME'	4M	300MM	AS SHOWN	✓	118
CALLISTEMON 'GREEN JOHN'	1M	200MM	AS SHOWN	✓	21
CALLISTEMON 'SLIM'	1.5M	300MM	AS SHOWN	✓	391
CALLISTEMON 'WHITE ANZAC'	1.2M	200MM	AS SHOWN	✓	10
CORREA 'COLIBAN RIVER'	1.5M	200MM	AS SHOWN		9
PANDOREA PANDORANA (WONGA WONGA VINE)	4M (CLIMBING)	300MM	2/M2	✓	-
RHAPHIOLEPIS 'ORIENTAL PEARL'	0.8M	200MM	AS SHOWN		54
WESTRINGIA 'AUSSIE BOX'	1.5M	300MM	AS SHOWN	✓	10
GROUNDCOVERS					
BANKSIA 'BIRTHDAY CANDLES'	0.5M	200MM	4/M2	✓	-
CHRYSOCEPHALUM APICULATUM (YELLOW BUTTONS)	0.2M	150MM	6/M2	✓	-
GREVILLEA 'GOLD FEVER'	0.3M	150MM	5/M2	✓	-
GREVILLEA 'NEW BLOOD'	0.5M	200MM	3/M2	✓	-
GREVILLEA 'ROYAL MANTLE'	0.3M	150MM	5/M2	✓	-
HARDENBERGIA VIOLACEA (NATIVE SARSPARILLA)	0.4M	150MM	5/M2	✓	-
JUNIPERUS CONFERTA (JUNIPER)	0.3M	150MM	5/M2		-
MYOPORUM PARVIFOLIUM (CREEPING BOOBIALLA)	0.2M	150MM	4/M2	✓	-

\* INSTALL SIZE IS DETERMINED BY REQUIRED SIGHT LINE RETENTION - SEE TREE PLANTING STRATEGY ON LDA-03 AND LANDSCAPE DETAILS PAGE ON LDA-08 FOR MORE INFORMATION





TYPICAL LANDSCAPE DETAILS

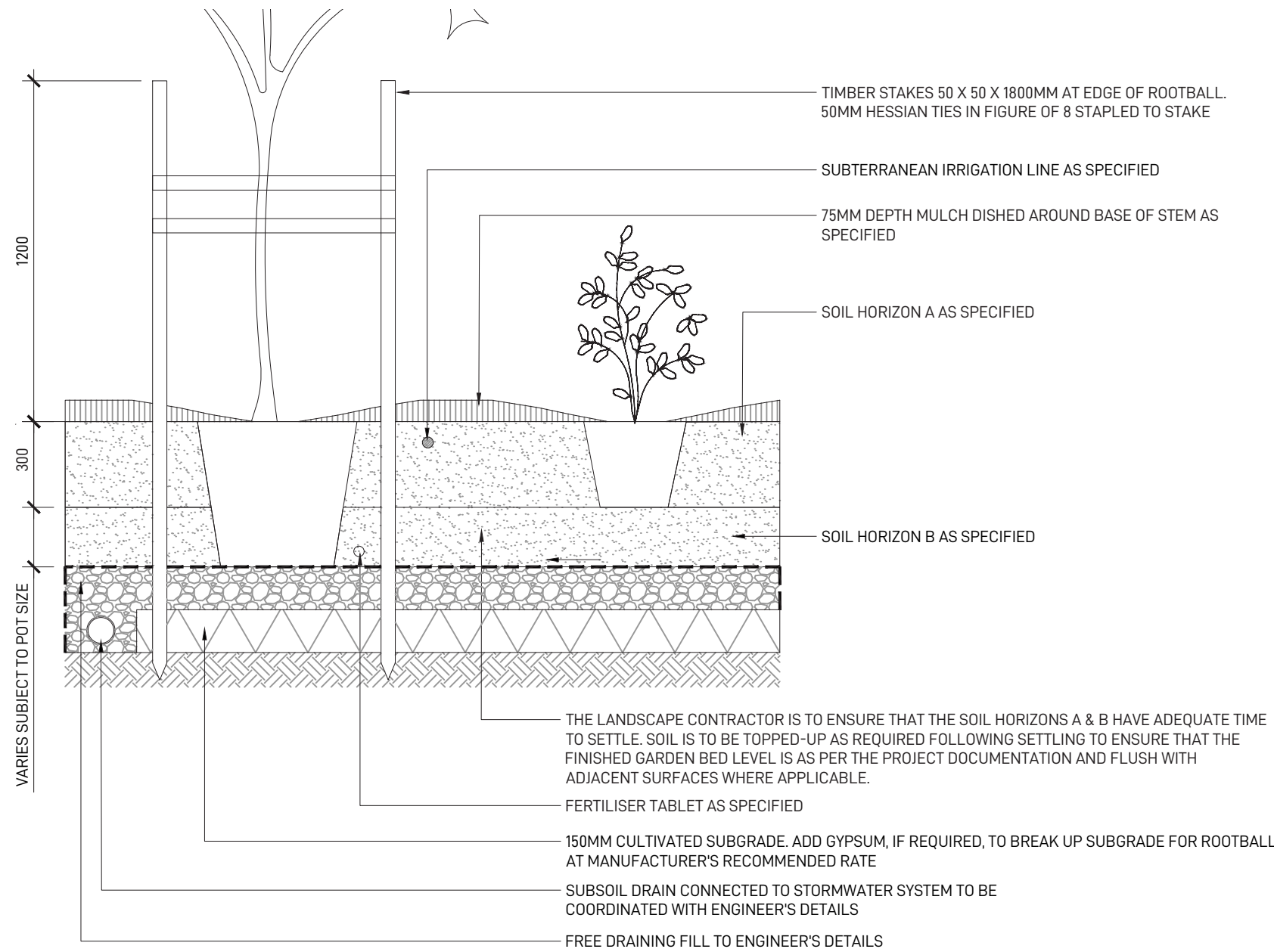

MASS PLANTING AND TREE DETAIL

TYPICAL SECTION

SCALE 1:20

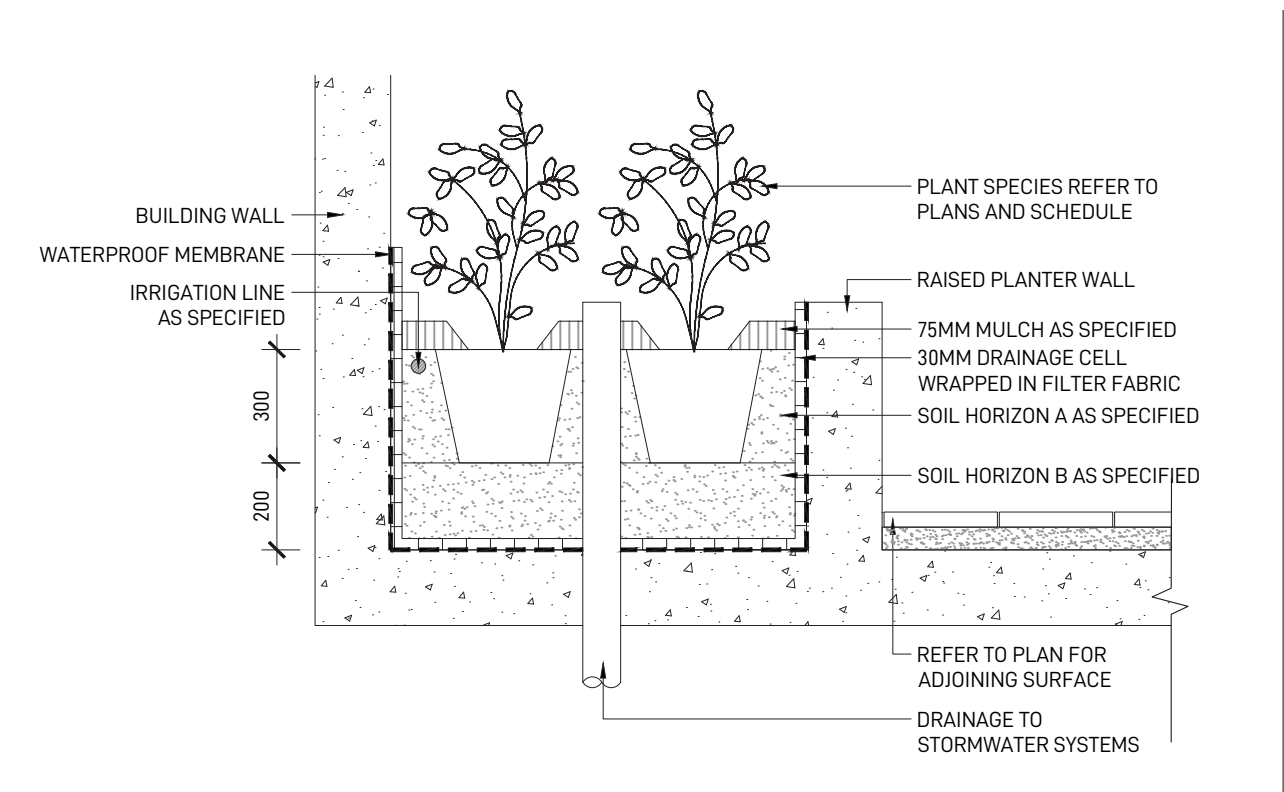

MASS PLANTING AND TREE DETAIL

TYPICAL SECTION

SCALE 1:20

OUTLINE LANDSCAPE SPECIFICATION

GENERAL

MAINTENANCE SHALL MEAN THE CARE AND MAINTENANCE OF THE LANDSCAPE WORKS BY ACCEPTED HORTICULTURAL PRACTICE AS RECTIFYING ANY DEFECTS THAT BECOME APPARENT IN THE LANDSCAPE WORKS UNDER NORMAL USE. THE LANDSCAPE CONTRACTOR SHALL ATTEND THE SITE ON A WEEKLY BASIS TO MAINTAIN THE LANDSCAPE WORKS FOR THE FULL TERM APPROVED AT CC STAGE OF THE MAINTENANCE PERIOD (COMMENCING FROM PRACTICAL COMPLETION).

RUBBISH REMOVAL

DURING THE TERM OF THE MAINTENANCE PERIOD THE LANDSCAPE CONTRACTOR SHALL UNDERTAKE RUBBISH REMOVAL FROM THE SITE ON A WEEKLY BASIS TO ENSURE THE SITE REMAINS IN TIDY CONDITION.

WEED ERADICATION

WEED GROWTH THAT MAY OCCUR IN, PLANTED OR MULCHED AREAS IS TO BE REMOVED USING ENVIRONMENTALLY ACCEPTABLE METHODS I.E. NON-RESIDUAL GLYPHOSATE HERBICIDE, (E.G. 'ROUNDUP', APPLIED IN ACCORDANCE WITH THE MANUFACTURER'S DIRECTIONS) OR HAND WEEDING.

TREE REPLACEMENT

TREES SHALL SHOW SIGNS OF HEALTHY VIGOROUS GROWTH AND BE FREE FROM DISEASE AND NOT EXHIBIT SIGNS OF STRESS PRIOR TO HANDOVER TO THE CLIENT. ANY TREES OR PLANT THAT DIE OR FAIL TO THRIVE, OR ARE DAMAGED OR STOLEN WILL BE REPLACED. REPLACEMENT MATERIAL SHALL HAVE THE MAINTENANCE PERIOD EXTENDED IN ACCORDANCE WITH THE LANDSCAPE CONTRACT CONDITIONS. TREES AND PLANT MATERIALS SHALL BE EQUAL TO THE MINIMUM REQUIREMENTS OF SPECIES SPECIFIED AND APPROVED MATERIAL DELIVERED TO SITE. SHOULD THE CONDITION DECLINE FROM THE APPROVED SAMPLE THE SUPERINTENDENT RESERVES THE RIGHT TO REJECT THE TREE / PLANTS. FREQUENCY: AS REQUIRED.

PRUNING

SELECTIVE PRUNING MAY BE REQUIRED DURING THE ESTABLISHMENT PERIOD TO PROMOTE A BALANCED CANOPY STRUCTURE. THESE ACTIVITIES SHALL BE CARRIED OUT TO THE BEST HORTICULTURAL AND INDUSTRY PRACTICE. ALL PRUNED MATERIAL IS TO BE REMOVED FROM SITE.

IRRIGATION

A LOW VOLUME DRIP IRRIGATION SYSTEM TO BE INSTALLED BY A QUALIFIED IRRIGATION ENGINEER. POSITION OF CONTROL BOX, SOLENOIDS AND IRRIGATION CONDUITS TO BE DESIGNED BY THE QUALIFIED IRRIGATION ENGINEER AT CC STAGE. CONTROLLERS SHALL BE MOUNTED ON A STABLE WALL, POWER RACK, OR FORMED AND CONSTRUCTED CONCRETE BASED PEDESTAL MOUNT. PERFORMANCE SPECIFICATION TO BE PROVIDED BY LANDSCAPE ARCHITECT, NOMINALLY 25MM DELIVERED TO PLANT AREAS EACH WEEK DURING ESTABLISHMENT (DEPENDING ON WEATHER CONDITIONS). AFTER ESTABLISHMENT, IRRIGATION RATES CAN BE DECREASED IN CERTAIN AREAS OF THE LANDSCAPE DEPENDING ON THE SPECIES.

WATERING

IMPLEMENT AN APPROPRIATE HAND WATERING REGIME TO MAINTAIN PLANT HEALTH AND VIGOUR. THE PROGRAM SHALL REFLECT SEASONAL CONDITIONS AND PLANT SPECIES. FREQUENCY: WEEKLY OR AS REQUIRED.

DRAINAGE

ALL LANDSCAPE AREAS ARE TO HAVE POSITIVE DRAINAGE TO SW SYSTEMS. IF AREAS OF POOR DRAINAGE ARE IDENTIFIED ON SITE THEN THIS SHOULD BE BROUGHT TO THE SITE SUPERINTENDENTS ATTENTION. INSTALL AGG LINES IF REQUIRED.

SOILS

HORIZON A - GARDEN BEDS ON NATURAL GROUND

A SANDY LOAM TO CLAY LOAM TOPSOIL MIX DESIGNED FOR GENERAL PURPOSE, ON-GRADE LANDSCAPE GARDEN BED PLANTING OF GRASSES, WOODY AND HERBACEOUS ANNUALS AND PERENNIALS THAT HAVE HIGH NUTRIENT REQUIREMENT FOR SUSTAINED OPTIMUM GROWTH, AND ARE NOT SUBJECT TO COMPACTION BY PEDESTRIAN AND OTHER FOOT TRAFFIC. HEAVIER TEXTURED SOILS IN THIS SPECIFICATION MAY REQUIRE ENGINEERED SOLUTIONS WHERE EXCESSIVE WETNESS IS ANTICIPATED. NOTE THAT ORGANIC SOIL VARIANT SHOULD NOT BE CHOSEN FOR LOW P PLANTINGS AND SHOULD NOT BE USED BELOW 300MM. PLANTING METHODS INCLUDE DIRECT SEEDING, TUBE AND POTTED SPECIMENS UP TO 45L.

HORIZON B – LARGER POTTED PLANTING BELOW 300MM

A SANDY, WELL DRAINED MEDIUM WITH LOW ORGANIC MATTER FOR BACKFILLING BELOW 300MM FROM THE SURFACE IN LARGER POTTED SPECIMENS OVER 45L OR 400MM DEPTH OF ROOT BALL, SEMI-ADVANCED, ADVANCED AND SUPER ADVANCED TREE PLANTING. THE SPECIFICATION MAY USE A SMALL PROPORTION OF SITE WON TOPSOIL OR SUBSOIL, PROVIDED THE ORGANIC MATTER UPPER LIMIT IS NOT EXCEEDED.

CULTIVATION

ALL GARDEN BEDS TO BE CULTIVATED TO A MIN DEPTH OF 150MM AND TREE PITS TO THE DEPTH OF THE ROOT BALL ONLY. IF ADDITIVES SUCH AS GYPSUM ARE REQUIRED CONDUCT THIS AFTER CULTIVATION INTO THE TOP 100MM OF SOIL.

PLANTING

ALL PLANTING TO BE GROWN TO NATSPEC SPECIFICATIONS. CONTRACTOR TO PREPARE SITE FOR PLANTING INCLUDING WATERING, HANDLING, SETTING OUT AND EXCAVATION. EXCAVATE A HOLE FOR EACH PLANT LARGE ENOUGH TO PROVIDE NOT LESS THAN 100MM ALL AROUND THE ROOT SYSTEM OF THE PLANT. FOR TREE PLANTING EACH HOLE SHALL BE DUG WITH A SHOVEL, BACKHOE OR SIMILAR TOOL. INDIVIDUAL HOLES SHALL BE EXCAVATED TO ALLOW ROOT SYSTEM TO SIT FLAT ON THE EXCAVATED HOLE AND 400MM TO EACH SIDE OF THE ROOT SYSTEM. BACKFILL PLANTING HOLES WITH EXISTING SITE SOIL AND TOPSOIL AS DESCRIBED IN SECTION 'SOIL'. PLANT / TREE SHALL BE SET PLUMB, WITH THE ROOT BALL SET SLIGHTLY BELOW THE FINAL SOIL LEVEL.

MULCHING

THE LANDSCAPE CONTRACTOR SHALL SUPPLY AND INSTALL 10MM PINE BARK MULCH TO ALL GARDEN BEDS SHOWN ON THE LANDSCAPE PLANS, TO A MINIMUM DEPTH OF 75MM. ALL MULCH IS TO BE FREE OF DELETERIOUS MATTER SUCH AS SOIL, WEEDS AND STICKS. MULCHED SURFACES ARE TO BE KEPT CLEAN AND TIDY AND FREE OF ANY DELETERIOUS MATERIAL AND FOREIGN MATTER. REINSTATE DEPTHS TO A UNIFORM LEVEL OF 75MM WITH MULCH AS SPECIFIED, MULCH TO BE FREE OF ANY WOOD MATERIAL IMPREGNATED WITH CCA OR SIMILAR TOXIC TREATMENT. MAINTAIN WATERING RINGS AROUND TREES. TOP UP MULCH LEVELS PRIOR TO HANDOVER TO CLIENT.

PEST AND DISEASE CONTROL

THE LANDSCAPE CONTRACTOR SHALL SPRAY FOR PESTS AND DISEASE INFESTATIONS WHEN THE PEST AND FUNGAL ATTACK HAS BEEN POSITIVELY IDENTIFIED AND WHEN THEIR POPULATIONS HAVE INCREASED TO A POINT THAT WILL BECOME DETRIMENTAL TO PLANT GROWTH. APPLY ALL PESTICIDES TO MANUFACTURER'S DIRECTIONS. FREQUENCY: WEEKLY INSPECTION

FERTILISING

PELLETS SHALL BE IN THE FORM INTENDED TO UNIFORMLY RELEASE PLANT FOOD ELEMENTS FOR A PERIOD OF APPROXIMATELY NINE MONTHS EQUAL TO SHIRLEYS KOKEI PELLETS, ANALYSIS 6.3:1.8:2.9 OR SIMILAR APPROVED. KOKEI PELLETS SHALL BE PLACED AT THE TIME OF PLANTING TO THE BASE OF THE PLANT, 50MM MINIMUM FROM THE ROOT BALL AT A RATE OF TWO PELLETS PER 300MM OF TOP GROWTH TO A MAXIMUM OF 8 PELLETS PER TREE. GENERALLY CHECK FOR SIGNS OF NUTRIENT DEFICIENCIES (YELLOWING OF LEAVES, FAILURE TO THRIVE), AND ADAPT FERTILISER REGIME TO SUIT. FERTILISER SHOULD BE APPLIED AT THE BEGINNING AND THE END OF THE (SUMMER) GROWING SEASON.

LANDSCAPE ARCHITECT		CLIENT		ARCHITECT		NOTE		ISSUE		DATE		DESCRIPTION		DRAWN		CHECKED		DRAWING TITLE		DATE		JOB NUMBER		DRAWN		CHECKED		DRAWING NUMBER	
<div>GROUND <b>ink</b></div> <div>SUITE 201, 75 ARCHER ST, CHATSWOOD NSW 2067 PH. (02) 9411 3279 WWW.GROUNDINK.COM.AU ABN 55 163 025 456 ACN 163 025 456 © GROUND INK PTY LTD THIS DESIGN AND DRAWING IS PROTECTED BY COPYRIGHT.</div>		<div>WOOLWORTHS GROUP</div> <div>1 WOOLWORTHS WAY, BELLA VISTA NSW 2153 PH. (02) 8885 0000 WWW.WOOLWORTHSGROUP.COM.AU</div>		<div>nettletontribe</div> <div>117 WILLOUGHBY RD, CROWS NEST NSW 2065 PH. (02) 9431 6431 WWW.NETTLETONTRIBE.COM.AU</div>		VERIFY ALL DIMENSIONS ON SITE BEFORE COMMENCING WORK. REPORT ALL DISCREPANCIES TO LANDSCAPE ARCHITECT PRIOR TO CONSTRUCTION. FIGURED DIMENSIONS TO BE TAKEN IN PREFERENCE TO SCALED DRAWINGS. ALL WORK IS TO CONFORM TO RELEVANT AUSTRALIAN STANDARDS AND OTHER CODES AS APPLICABLE. LOCATION OF UNDERGROUND SERVICES TO BE PROVEN ON SITE AND PROTECTED IF NECESSARY PRIOR TO CONSTRUCTION. DIAL BEFORE YOU DIG. PLANT SPECIES AND QUANTITIES SHOWN ARE INDICATIVE ONLY AND ARE SUBJECT TO CHANGE BASED ON FUTURE PROJECT REQUIREMENTS.		A		26.04.23		ISSUE FOR CO-ORDINATION		AG		RL		LANDSCAPE DETAILS		04-SEP-24		20230214		QN		RL		LDA-08	
								B		01.06.23		ISSUE FOR DA		AG		RL													
								C		28.02.24		ISSUE FOR DA		MK		RL													
								D		18.04.24		ISSUE FOR DA		QN		RL													
								E		04.09.24		ISSUE FOR DA		QN		RL													